



SLOTTED ANGLE **RACKS**



APEX TECH STORAGE SOLUTION

Website :- www.apextechstorage.com



APEXTECH supplies prefabricated storage racks, shelves etc. as well and we can install customised shelving, and pigeon-hole racks, at the customer's place using heavy-duty APEXTECH slotted angles. APEXTECH shelving units are 20 & 18-gauge steel with load capacities of up to 630 lb (285 kg) per shelf. Our shelving can be used in multi-tier applications with access stairways and catwalks. Multi-tier or mezzanine shelving is one of our speciality areas, and we construct them two or three levels high.



Website :- www.bestracks.in



SLOTTED ANGLE - FILING RACKS

Filing Racks - 2100mm (7')				
Width	Depth	Levels	Load/Level	Load/Rack
600mm(24")	300mm(12")	6	50 Kg	300 Kg
750mm(30")	300mm(12")	6	50 Kg	300 Kg
900mm(36")	300mm(12")	6	50 Kg	300 Kg
1200mm(48")	300mm(12")	6	50 Kg	300 Kg
Filing Racks - 2400mm (8')				
Width	Depth	Levels	Load/Level	Load/Rack
600mm(24")	300mm(12")	7	50 Kg	350 Kg
750mm(30")	300mm(12")	7	50 Kg	350 Kg
900mm(36")	300mm(12")	7	50 Kg	350 Kg
1200mm(48")	300mm(12")	7	50 Kg	350 Kg
Filing Racks - 3000mm (10')				
Width	Depth	Levels	Load/Level	Load/Rack
600mm(24")	300mm(12")	8	50 Kg	400 Kg
750mm(30")	300mm(12")	8	50 Kg	400 Kg
900mm(36")	300mm(12")	8	50 Kg	400 Kg
1200mm(48")	300mm(12")	8	50 Kg	400 Kg

Website :- www.apextechstorage.com

SLOTTED ANGLE - STORAGE RACKS

Storage Racks - 2000mm (6'6")				
Width	Depth	Levels	Load/Level	Load/Rack
600mm(24")	300mm(12")	5	50 Kg	250 Kg
600mm(24")	375mm(15")	5	50 Kg	250 Kg
600mm(24")	450mm(18")	5	50 Kg	250 Kg
600mm(24")	600mm(24")	5	50 Kg	250 Kg
Storage Racks - 2000mm (6'6")				
Width	Depth	Levels	Load/Level	Load/Rack
750mm(30")	300mm(12")	5	50 Kg	250 Kg
750mm(30")	375mm(15")	5	50 Kg	250 Kg
750mm(30")	450mm(18")	5	50 Kg	250 Kg
750mm(30")	600mm(24")	5	50 Kg	250 Kg
Storage Racks - 2000mm (6'6")				
Width	Depth	Levels	Load/Level	Load/Rack
900mm(36")	300mm(12")	5	50 Kg	250 Kg
900mm(36")	375mm(15")	5	50 Kg	250 Kg
900mm(36")	450mm(18")	5	50 Kg	250 Kg
900mm(36")	600mm(24")	5	50 Kg	250 Kg
Storage Racks - 2000mm (6'6")				
Width	Depth	Levels	Load/Level	Load/Rack
1200mm(48")	300mm(12")	5	50 Kg	250 Kg
1200mm(48")	375mm(15")	5	50 Kg	250 Kg
1200mm(48")	450mm(18")	5	50 Kg	250 Kg
1200mm(48")	600mm(24")	5	50 Kg	250 Kg

Website :- www.apextechstorage.com



SLOTTED ANGLE - STORAGE RACKS

Storage Racks - 2400mm (8')				
Width	Depth	Levels	Load/Level	Load/Rack
600mm(24")	300mm(12")	6	50 Kg	300 Kg
600mm(24")	375mm(15")	6	50 Kg	300 Kg
600mm(24")	450mm(18")	6	50 Kg	300 Kg
600mm(24")	600mm(24")	6	50 Kg	300 Kg
Storage Racks - 2400mm (8')				
Width	Depth	Levels	Load/Level	Load/Rack
750mm(30")	300mm(12")	6	50 Kg	300 Kg
750mm(30")	375mm(15")	6	50 Kg	300 Kg
750mm(30")	450mm(18")	6	50 Kg	300 Kg
750mm(30")	600mm(24")	6	50 Kg	300 Kg
Storage Racks - 2400mm (8')				
Width	Depth	Levels	Load/Level	Load/Rack
900mm(36")	300mm(12")	6	50 Kg	300 Kg
900mm(36")	375mm(15")	6	50 Kg	300 Kg
900mm(36")	450mm(18")	6	50 Kg	300 Kg
900mm(36")	600mm(24")	6	50 Kg	300 Kg
Storage Racks - 2400mm (8')				
Width	Depth	Levels	Load/Level	Load/Rack
1200mm(48")	300mm(12")	6	50 Kg	300 Kg
1200mm(48")	375mm(15")	6	50 Kg	300 Kg
1200mm(48")	450mm(18")	6	50 Kg	300 Kg
1200mm(48")	600mm(24")	6	50 Kg	300 Kg

Website :- www.apextechstorage.com



SLOTTED ANGLE - STORAGE RACKS

Storage Racks - 3000mm (10')				
Width	Depth	Levels	Load/Level	Load/Rack
600mm(24")	300mm(12")	7	50 Kg	350 Kg
600mm(24")	375mm(15")	7	50 Kg	350 Kg
600mm(24")	450mm(18")	7	50 Kg	350 Kg
600mm(24")	600mm(24")	7	50 Kg	350 Kg
Storage Racks - 3000mm (10')				
Width	Depth	Levels	Load/Level	Load/Rack
750mm(30")	300mm(12")	7	50 Kg	350 Kg
750mm(30")	375mm(15")	7	50 Kg	350 Kg
750mm(30")	450mm(18")	7	50 Kg	350 Kg
750mm(30")	600mm(24")	7	50 Kg	350 Kg
Storage Racks - 3000mm (10')				
Width	Depth	Levels	Load/Level	Load/Rack
900mm(36")	300mm(12")	7	50 Kg	350 Kg
900mm(36")	375mm(15")	7	50 Kg	350 Kg
900mm(36")	450mm(18")	7	50 Kg	350 Kg
900mm(36")	600mm(24")	7	50 Kg	350 Kg
Storage Racks - 3000mm (10')				
Width	Depth	Levels	Load/Level	Load/Rack
1200mm(48")	300mm(12")	7	50 Kg	350 Kg
1200mm(48")	375mm(15")	7	50 Kg	350 Kg
1200mm(48")	450mm(18")	7	50 Kg	350 Kg
1200mm(48")	600mm(24")	7	50 Kg	350 Kg

Website :- www.apextechstorage.com



SLOTTED ANGLE - ANGLE FRAMEWORK RACKS

Angle Framework Racks - 2000mm (6'6")				
Width	Depth	Levels	Load/Level	Load/Rack
1200mm(4')	900mm(3')	4	180-200 Kg	720-800 Kg
1800mm(6')	900mm(3')	4	280-300 Kg	1120-1200 Kg
1800mm(6')	1200mm(4')	4	430-450 Kg	1720-1800 Kg
Angle Framework Racks - 2400mm (8')				
Width	Depth	Levels	Load/Level	Load/Rack
1200mm(4')	900mm(3')	5	180-200 Kg	900-1000 Kg
1800mm(6')	900mm(3')	5	280-300 Kg	1400-1500 Kg
1800mm(6')	1200mm(4')	5	430-450 Kg	2150-2250 Kg
Angle Framework Racks - 3000mm (10')				
Width	Depth	Levels	Load/Level	Load/Rack
1200mm(4')	900mm(3')	6	180-200 Kg	1080-1200 Kg
1800mm(6')	900mm(3')	6	280-300 Kg	1680-1800 Kg
1800mm(6')	1200mm(4')	6	430-450 Kg	2580-2700 Kg

Website :- www.apextechstorage.com



Components

Slotted Angle:

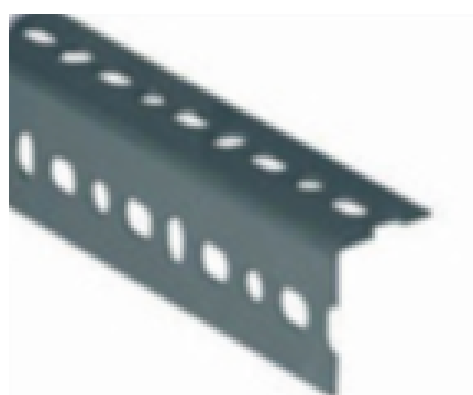

40mmx40mm

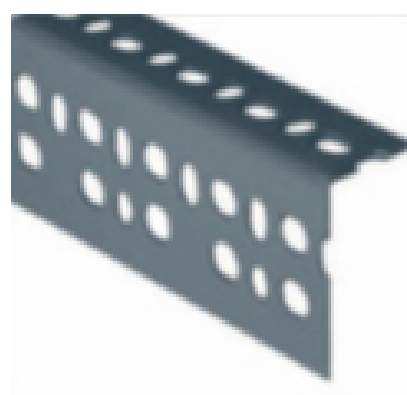

60mmx40mm

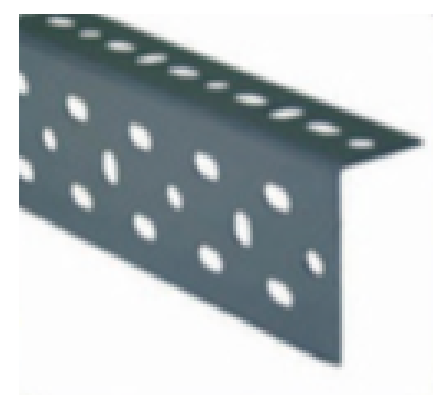

80mmx40mm

Length available (mm) : 1800, 2000, 2500, 3000

Thickness available:

40x40mm, 60x40mm - 1.8mm & 2mm

80x40mm - 2.5mm

Slotted Channel:

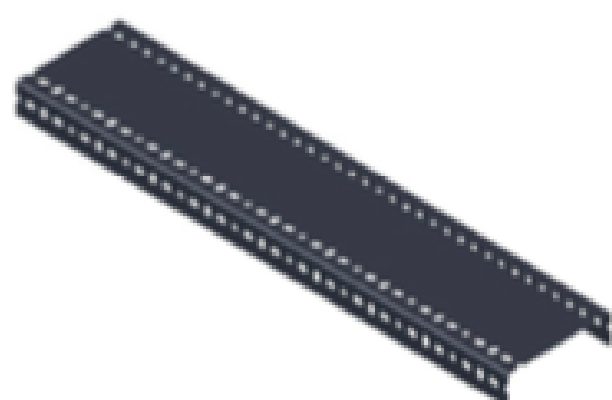

40mmx75mmx40mm



40mmx150mmx40mm

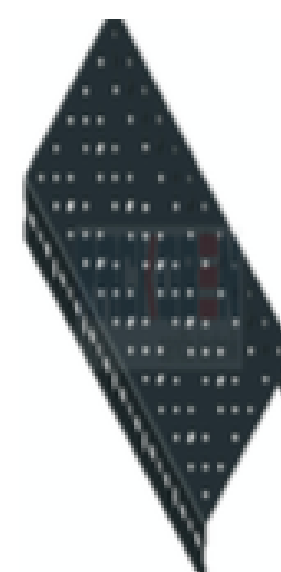

40mmx225mmx40mm

Length available (mm) : 1800, 2000, 2500, 3000

Thickness available:

1.8mm, 2mm & 2.5mm

Website :- www.apextechstorage.com



Sheet Shelves:



Width (length): 24" (600mm), 30"(750mm), 36"(900mm), 39" (1000mm) & 48" (1200mm)

Depth: 9"(225MM), 12"(300MM), 15"(375MM), 18" (450MM) & 24" (600MM)

Thickness: 21G, 20G,19G, 18G & 16G

Sectional Panels:

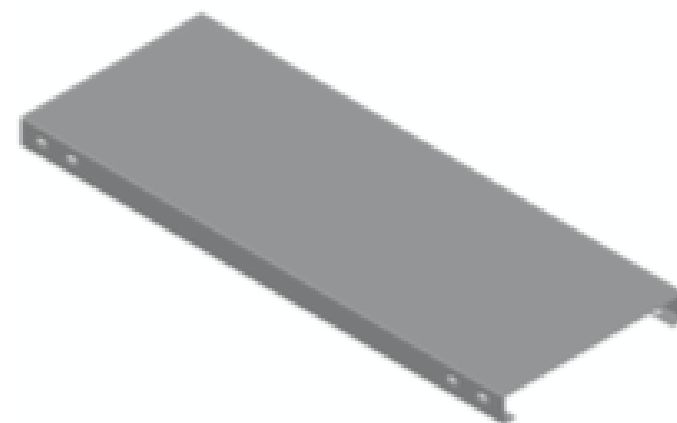

Width (length): 24" (600mm), 30"(750mm), 36"(900mm), 39" (1000mm),
48" (1200mm) & 60"(1500mm)

Depth: 9"(225MM) &12"(300MM)

Thickness: 21G, 20G,19G, 18G & 16G

Website :- www.apextechstorage.com



Partition Plates:

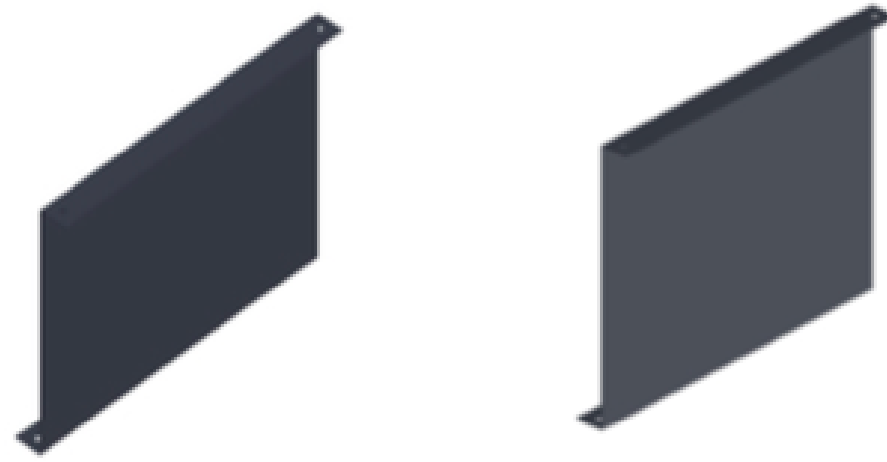

Cladding Sheet:

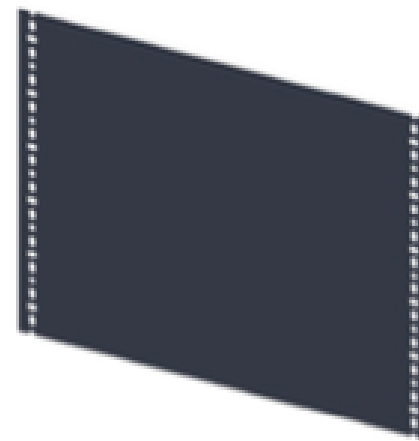

Front Guard:



Punch Strips:

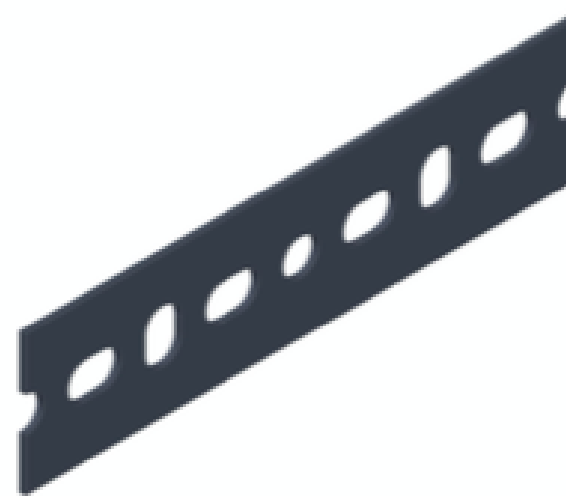

Accessories:



Corner plates

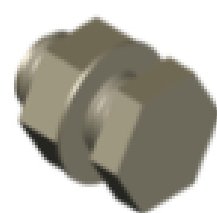

Nut & bolts

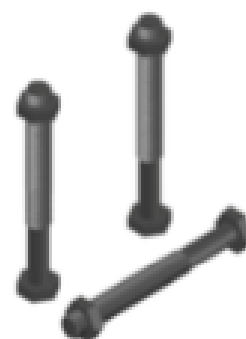

Plastic shoes



Website :- www.apextechstorage.com



APEXTECH has been leading in the development and manufacture of Quality Storage Systems with modern production facilities.

Our Quality assurance by NV to ISO 9001:2008 has enabled APEXTECH to produce Quality Products in the Steel Section, engineering a perfect Storage System" with high-quality standards.

At APEXTECH we make our products with well-acquainted and experienced staff. Precision and accuracy cannot be overlooked. With long-term consumer relationships in mind, we continue to strive for the highest standards in services and quality products to ensure complete satisfaction

APEX TECH STORAGE SOLUTION

www.apextechstorage.com